

Sites # 5 and # 4 WSDOT sites Wilson Creek Cherry Creek



KITITITAS COUNTY COMMUNITY DEVELOPMENT SERVICES

411 N. Ruby St., Suite 2, Ellensburg, WA 98926
CDS@CO.KITITITAS.WA.US
Office (509) 962-7506
Fax (509) 962-7682

"Building Partnerships – Building Communities"

SHORELINE EXEMPTION PERMITTING

(For projects located within 200 feet of a body of water and/or associated floodway and wetlands under the jurisdiction of the Shoreline Master Program)

REQUIRED INFORMATION/ATTACHMENTS



- A scaled site plan is required showing location of all structures, driveways, well, septic, fences, etc. and proposed uses and distances from property lines, river, and Horizontal distance from OHWM. To show the Horizontal distance a profile view from the OHWM to the edge of structure/activity shall also be shown.
- Include JARPA or HPA forms *if required* for your project by a state or federal agency.
- SEPA Checklist, if not exempt per WAC 197-11-800.

Please note a Shoreline Variance or Shoreline Conditional Use Permit may also be required. See Kittitas County Shoreline Master Program

APPLICATION FEES:

\$540.00	Kittitas County Community Development Services
\$550.00	Kittitas County Public Works
\$1,090.00	Fees due for this application when SEPA is not required
\$2,220.00	Fees due for this application when SEPA is required (One check made payable to KCCDS)

FOR STAFF USE ONLY

Application Received By (CDS Staff Signature): 	DATE: 10/11/18	RECEIPT #	

COMMUNITY PLANNING • BUILDING INSPECTION • PLAN REVIEW • ADMINISTRATION • PERMIT SERVICES • CODE ENFORCEMENT • FIRE INVESTIGATION

Project Description

1. Briefly summarize the purpose of the project:

Temporary monitoring of water quality parameters for a water quality restoration project by the Washington State Department of Ecology.
Monitoring equipment will be installed (hand tools only) in the fall of 2018 at each site and maintained/operated until end of 2019, when equipment will be removed.

2. What is the primary use of the project (e.g. Residential, Commercial, Public, Recreation)?

Public water quality restoration project by the Washington State Department of Ecology

3. What is the specific use of the project (e.g. single family home, subdivision, boat launch, restoration project)?

Collect monitoring data for water quality restoration project by the Washington State Department of Ecology

4. Fair Market Value of the project, including materials, labor, machine rentals, etc. < \$ 15,000 each

5. Anticipated start and end dates of project construction: Start: October 2018 End: December 2019 (take out)

Authorization

Application is hereby made for permit(s) to authorize the activities described herein. I certify that I am familiar with the information contained in this application, and that to the best of my knowledge and belief such information is true, complete, and accurate. I further certify that I possess the authority to undertake the proposed activities. I hereby grant to the agencies to which this application is made, the right to enter the above-described location to inspect the proposed and or completed work.

All correspondence and notices will be transmitted to the Land Owner of Record and copies sent to the authorized agent or contact person, as applicable.

Signature of Authorized Agent:
(REQUIRED if indicated on application)

Date:

X

10-11-18

Signature of Land Owner of Record
(Required for application submittal):

Date:

X

10-4-18

Troy A. Suling

Impervious Surfaces

11. Will the project result in creation of over 500 square feet of impervious surfaces?

Yes

No

If 'Yes', how much impervious surface will be created? _____ (square feet and acres)

12. Will the project result in removal of impervious surfaces?

Yes

No

If 'Yes', how much impervious surface will be removed? _____ (square feet and acres)

Shoreline Stabilization

13. Will the project result in creation of structural shoreline stabilization structures (revetment/bulkhead/riprap)?

Yes

No

If 'Yes', what is the net linear feet of stabilization structures that will be created? _____

14. Will the project result in removal of structural shoreline stabilization structures (revetment/bulkhead/riprap)?

Yes

No

If 'Yes', what is the net linear feet of stabilization structures that will be removed? _____

Levees/Dikes

15. Will the project result in creation, removal, or relocation (setting back) of levees/dikes?

Yes

No

If 'Yes', what is the net linear feet of levees/dikes that will be created? _____

If 'Yes', what is the net linear feet of levees/dikes that will be permanently removed? _____

If 'Yes', what is the linear feet of levees/dikes that will be reconstructed at a location further from the OHWM? _____

Floodplain Development

16. Will the project result in development within the floodplain? (check one)

Yes

No

If 'Yes', what is the net square feet of structures to be constructed in the floodplain? _____

**Note: A floodplain development is required per KCC 14.08; please contact Kittitas County Public Works*

17. Will the project result in removal of existing structures within the floodplain? (check one)

Yes

No

If 'Yes', what is the net square footage of structures to be removed from the floodplain? _____

SITES # 4 and # 5 Wilson and Cherry Ck (wsDOT)

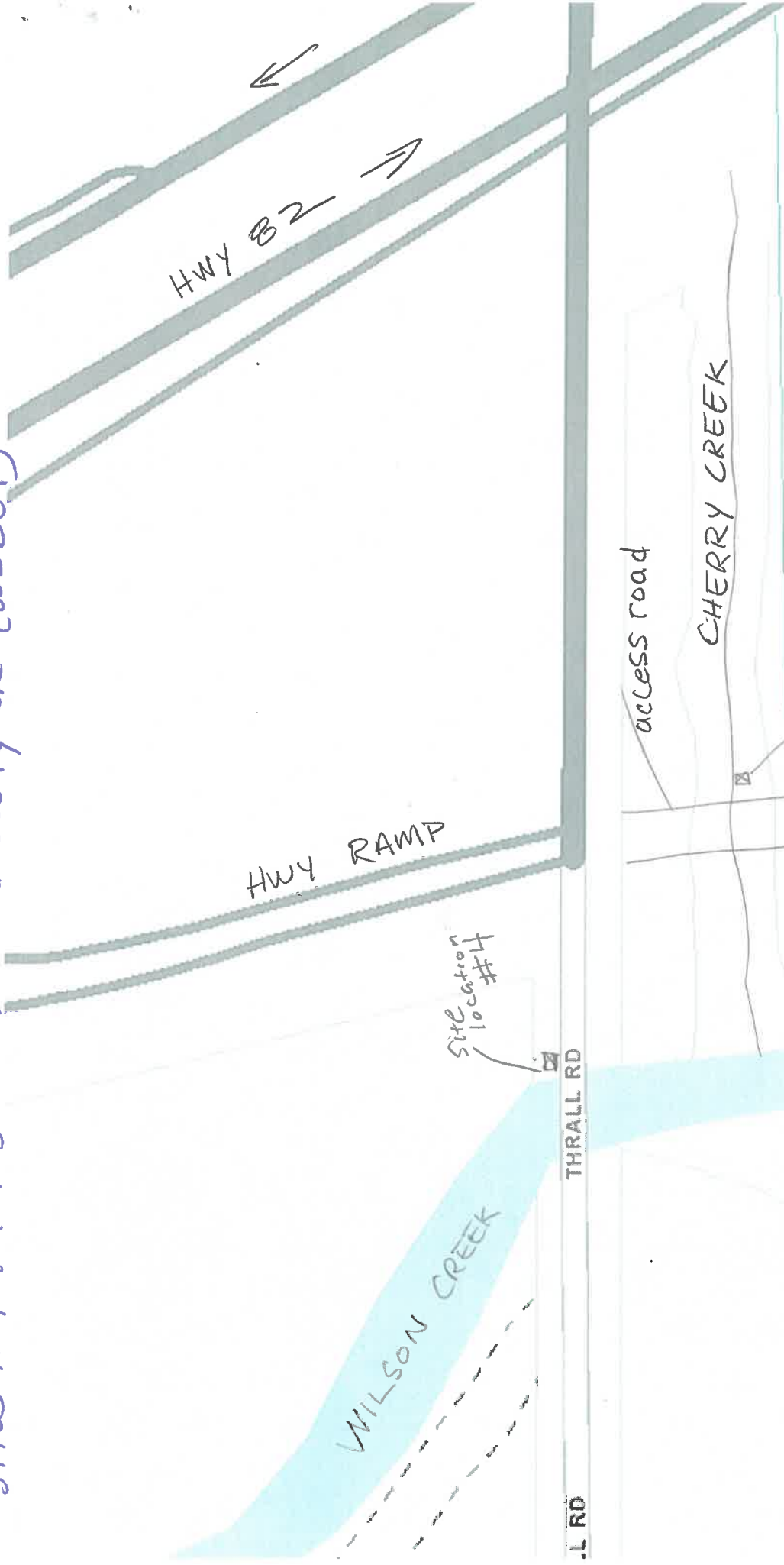

RECEIVED
 OCT 11 2018
 Kittitas County CDS

640323

Site #4
WILSON CK @ THRALL ROAD (WSDOT)

10
x
10

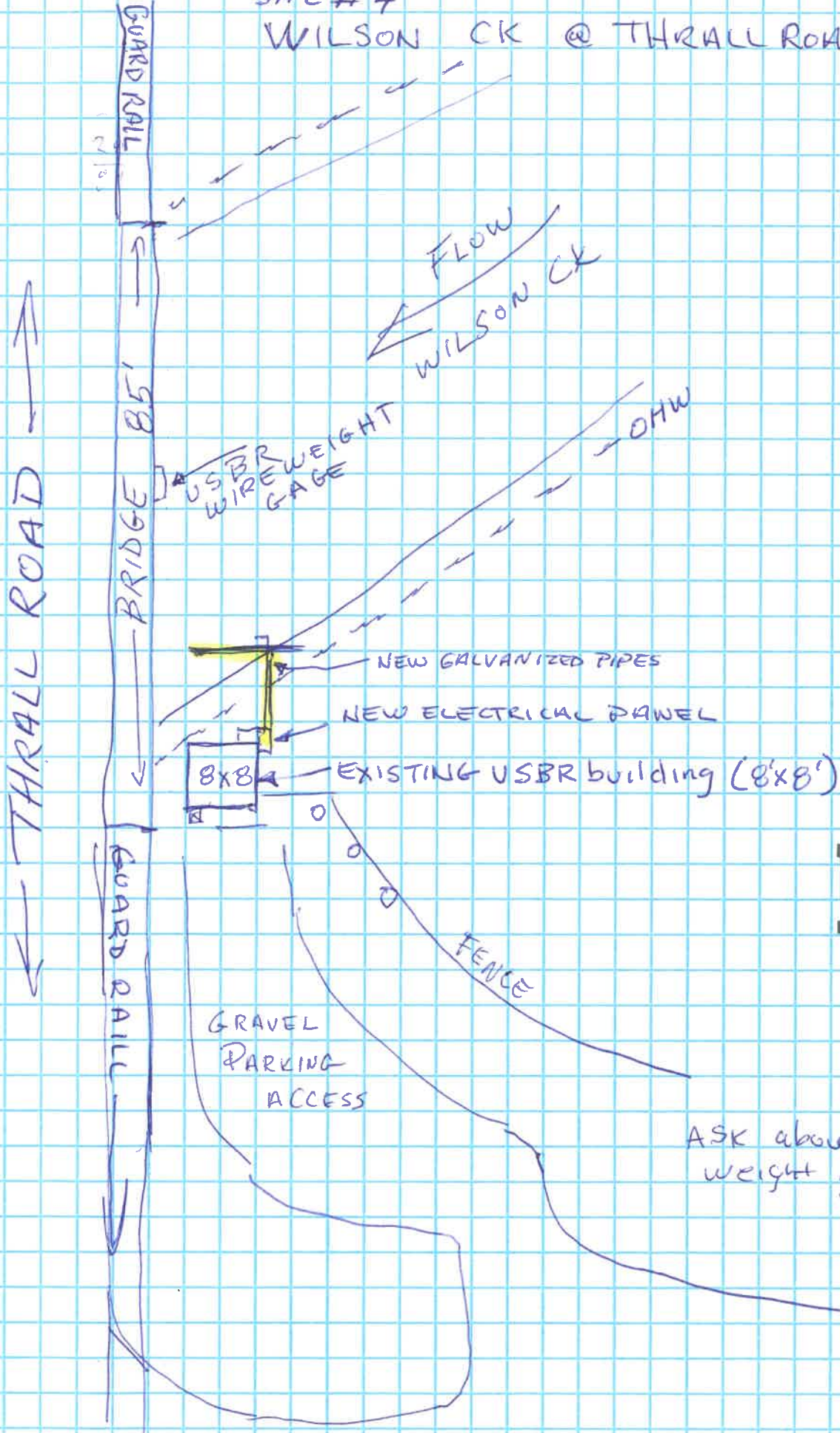

RECEIVED
OCT 11 2018

Kittitas County CDS

ASK about key to wire weight gage box ?

VITE 4-7 WILSON - REEK @ THEALC ROAD (WS DOT)

RECEIVED
OCT 11 2018
Kittitas County CDS



SITE #5

CHERRY CRK @ THRALL RD (WSDOT)

10x10 scale

ASK USBR about power

EXISTING USBR BUILDING

wire weight gage

CHERRYCK
Flow

45'

BRIDGE

ACCESS ROAD

THRALL ROAD

RECEIVED
OCT 11 2018
Kittitas County CDS

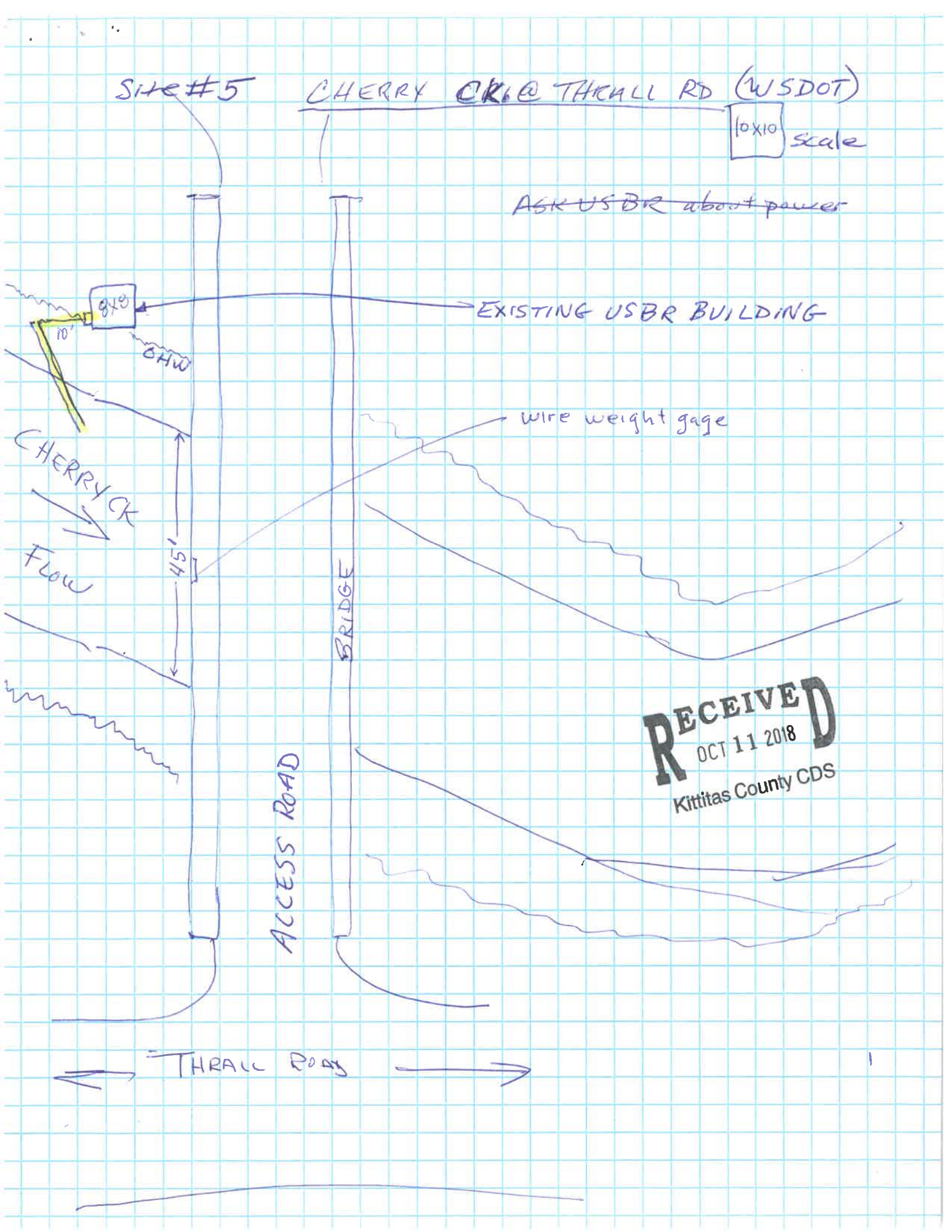

SITE #5 CHEROKEE CREEK @ THRALL ROAD (WSDOT)



THE COUNTY OF
CLATSOP
CLATSOP COUNTY
Astoria, Oregon